

CARACTÉRISTIQUES

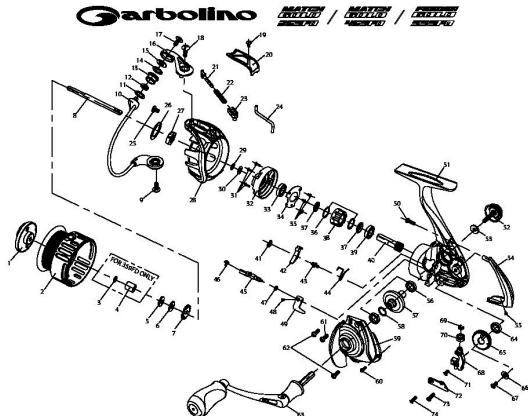

KEY NO.	PART NAME	DESCRIPTION	KEY NO.	PART NAME	DESCRIPTION
1	DRAG KNOB ASSEMBLY	BOUTON DE FREIN	38	ONE WAY CLUTCH ASSEMBLY	ANTIRETOUR MFN(WAR)
2	SPOKE ASSEMBLY	BOÎME COMPLÈTE	39	BALL BEARING	ROULEMENT À BILLES
3	O-RING (RIGHT ONLY)	JOINT TORQUE (RIGHT ONLY)	40	PINDIN	PINDIN
4	BUSHING (RIGHT ONLY)	ENTRETOISE (RIGHT ONLY)	41	SELF LOCKING WASHER	CROUPE
5	WASHER	RONDELLE	42	NIPPAW	DOIGTARI
6	WASHER	RONDELLE	43	NIPPAW STUD	AXE DOIGTARI
7	CLIX RATCHET	ROUE DÉVITE	44	NR SPRING	RESSORT COMMANDE ARI
8	MAIN SHAFT	AXE PRINCIPAL	45	NARSTEM	TIGE PLOTE ARI
9	SCREW	VE	46	NARSTEM SPRING	RESSORT TIGE PLOTE ARI
10	BALL ASSEMBLY	ANSE DE PANIER	47	O-RING	JOINT TORQUE
11	WASHER	RONDELLE	48	SCREW	VE
12	BALL BEARING	ROULEMENT À BILLES	49	NARLEVER	COMMANDE ARI
13	LINE ROLLER	GALET	50	SCREW	VE
14	WASHER	RONDELLE	51	FRAME	SÂTE
15	LINE ROLLER WASHER	RONDELLE DE GALET	52	HANDLE LOCK SCREW	BOUR MANIVELLE
16	BALL BRACKET	BRAS SUPPORT	53	WASHER	RONDELLE
17	SCREW	VE	54	REAR COVER	ENCLMELR
18	SCREW	VE	55	SCREW	VE
19	SCREW	VE	56	BALL BEARING	ROULEMENT À BILLES
20	BALL ARM COVER	CAPOT	57	DRIVE GEAR	ROUE DE COMMANDE
21	TOP LINK	TIGE GLEF RESSORT	58	DRIVE GEAR WASHER	RONDELLE
22	SLIDER SPRING	RESSORT COULESSANT	59	SIDE COVER	CAPOTÊATI
23	TRP SPRING HOLDER	GLIDE RESSORT	60	SCREW	VE
24	BALL TSP WIRE	TRINGLE	61	SCREW	VE
25	SCREW	VE	62	SCREW	VE
26	LOCK WASHER	RONDELLE FREIN	63	CRANK ASSEMBLY	BRAS DE MANIVELLE
27	POUR HOLDING NUT	FOURCOURTOR	64	BALL BEARING	ROULEMENT À BILLES
28	PLUJ DECAL	HARLAGE	65	LEVEL WIND GEAR	ROUE DÉVITE BOBINAGE CROSE
29	WASHER	RONDELLE	66	LEVEL WIND GEAR COVER	RONDELLE
30	WASHER	RONDELLE	67	SCREW	VE
31	SCREW	VE	68	LEVEL WIND BRACKET	COMMANDE BOBINAGE CROSE
32	BEARING HOLDER	SUPPORT ROULEMENT	69	SELF LOCKING WASHER	CROUPE
33	BALL BEARING	ROULEMENT À BILLES	70	BALL BEARING	ROULEMENT À BILLES
34	BEARING BASE PLATE	CAPOT ROULEMENT	71	SCREW	VE
35	SCREW	VE	72	L/W BRACKET PLATE	PLAQUE COMMANDE BOBINAGE CROSE
36	WASHER	RONDELLE	73	SCREW	VE
37	WASHER	RONDELLE	74	SCREW	VE

